

NOTES:

- THIS IS AN AUTOCAD DRAWING AND SHOULD NOT BE AMENDED BY HAND.
- THE EXISTING LOCATIONS ARE APPROXIMATE AND THEIR ACCURACY CANNOT BE GUARANTEED.
- ALL DIMENSIONS IN METRES UNLESS OTHERWISE STATED.
- THIS DRAWING MUST NOT BE SCALED.
- DRAWING TO BE READ IN CONJUNCTION WITH OTHER CONTRACT DOCUMENTS.
- THE SITING OF PROPOSED COLUMNS IS BASED ON UTILITY DRAWINGS PROVIDED BY THE RELEVANT DNO AND ON SITE SURVEYS WHERE POSSIBLE. IT IS THE RESPONSIBILITY OF THE INSTALLING ORGANISATION TO UNDERTAKE FINAL DUE DILIGENCE AND DETERMINE THE EXACT LOCATION OF THE DISTRIBUTION NETWORK(S) PRIOR TO COMMENCEMENT OF DIGGING WORKS ON SITE
- ALL LIGHTING EQUIPMENT IS TO BE IN ACCORDANCE WITH THE SPECIFIED MATERIALS OF THE LAMBETH PFI LIGHTING SPECIFICATION.
- ALL COLUMNS SHOULD BE LOCATED BACK OF PATH AND HAVE A MINIMUM SET BACK OF 800MM WHILST MAINTAINING PEDESTRIAN ACCESS. IF THIS IS NOT ACHIEVABLE THIS SHOULD BE NOTED ON THE DRAWING. COLUMNS IN VERGES SHOULD HAVE A MINIMUM SETBACK OF 800MM MINIMUM
- ALL SIGNS MOUNTED ON COLUMNS SHOULD BE A MINIMUM OF 2.3M ABOVE GROUND LEVEL.
- TREE PRUNING WILL BE NOTED WHERE REQUIRED ON THE DRAWINGS HOWEVER ADDITIONAL PRUNING MAY BE REQUIRED ONCE COLUMNS HAVE BEEN INSTALLED ON SITE DEPENDING ON GROWTH OF TREES SINCE DESIGN
- ALL ELECTRICAL DESIGN TO BE IN ACCORDANCE WITH BS7671:2008 (2011). SECONDARY ISOLATORS ARE TO BE FROM THE DOUBLE POLE CHARLES ENDIRECT LSIO RANGE, OR SIMILAR APPROVED.
- IF COLUMNS CANNOT BE INSTALLED WITHIN THE TOLERANCES SET OUT IN THE DESIGN WINDOW THEN THE DESIGNER WILL HAVE TO BE CONSULTED FOR NEW COLUMN POSITIONS.
- ALL LIGHTING IS TO BE SUPPLIED USING THE EXISTING PRIVATE CABLE NETWORK. IT IS FOR THE CONTRACTOR TO TEST AND CONFIRM THE SUITABILITY OF THE EXISTING NETWORK AND DECIDED WEATHER TO TRANSFER CONNECTIONS OVER OR CONSIDER A DNO CONNECTION IF THERE IS A PASSING DNO MAIN.
- COLUMN NUMBERING FOR DESIGN PURPOSES ONLY, THEY MAY NOT MATCH THOSE AS SEEN ON SITE.

It is assumed all existing Private Cable Networks are fit for purpose and can be reused, where extensions to networks are required the information is detailed. If the existing private cable network is not fit for purpose then the existing network routes need to be reported back to the electrical engineer for a new design to be carried out.

LIGHTING COLUMN LOCATED ON PRIVATE PROPERTY. RELOCATED TO PUBLIC FOOTPATH.

Notes:

- | Qty. | Symbol | Type of Lighting Unit |
|------|--------|--|
| 9 | | Proposed 6m steel post top column mounted at 0 degrees inclination with C U Phosco P852 STD - C0550 lantern 25W LED lamp (740p NW), to be controlled via a Photo Electric Control Unit. All equipment to be to the Lambeth PFI specification or similar approved. |
| 9 | | R&L Proposed Rise & Lower 6m steel post top column mounted at 0 degrees inclination with C U Phosco P852 STD - C0250 lantern 14W LED lamp (740p NW), to be controlled via a Photo Electric Control Unit. All equipment to be to the Lambeth PFI specification or similar approved. |
| | | Direction of fall for raise and lower column |
| 16 | | Existing road lighting column to be taken up or down and removed to tip off site. |
| 2 | | Existing twin arm lighting column to be taken up or down and removed to tip off site. |
| | | Existing CCTV camera |
| | | PCN Extension Line |
| | | Scheme Extents |
| | | Existing Tree (Approximate size and position) |

I:\NetworkStorage\Share\DFL_Network Drive\Projects\0474 Myatts Park Redesign_Regenter\02-Drawings\0474-DFL-1300.dwg

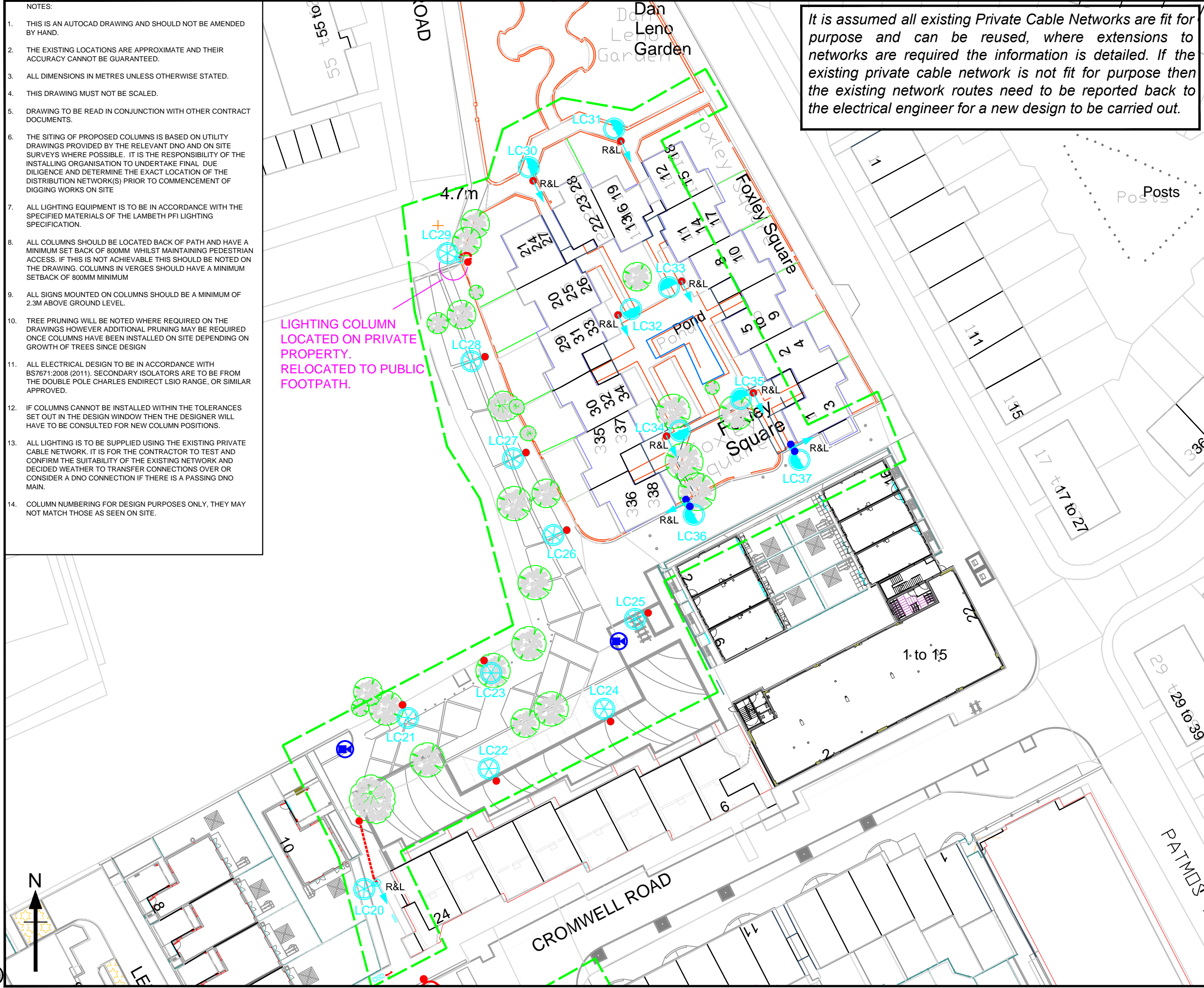

| | | | | | |
|-----|-------|-------|-------------|-----|----------|
| JRS | RJ | AL | First Issue | A | 28.10.16 |
| cad | chckd | appvd | Description | rev | date |

DL Designs for Lighting Ltd
 17 City Business Centre
 Winchester
 Hampshire
 SO23 7TA
 Tel: 01962 855080
 Email: info@designsforlighting.co.uk

CLIENT: **REGENER**

PROJECT: **MYATTS PARK**

DRAWING TITLE: **LIGHTING LAYOUT**

| | | | | | | | |
|----------------|---------------|-----|-------|---------|----|------------|----|
| DESIGNED | JRS | CAD | JRS | CHECKED | RJ | APPROVED | AL |
| DRAWING NUMBER | 0474-DFL-1300 | | SHEET | 2 of 2 | | REGION | A |
| JOB NUMBER | 0474 | | SCALE | 1:500 | | SHEET SIZE | A3 |