

Vary a Premises Licence

Review

Please review the details to below to ensure they are correct before proceeding. If the details shown are not correct, click previous to enter the correct licence number.

Current Licence number

19/00119/PRMNEW

Current Premises address

441 Coldharbour Lane London SW9 8LN

Premises Details

Premises Licence Number *

19/00119/PRMNEW

Premises Address *

441 Coldharbour Lane London SW9 8LN

Telephone Number at Premises (if any)

Non-domestic rateable value of premises. *

£ 23250

Type of Premises Licence Holder

Type of Premises Licence Holder *

Non-Individual(s)

Premises Licence Holder - Non Individual

Name *	PLANE TREE HOSPITALITY LTD
Street address *	128 ACRE LANE
Town/City *	LONDON
County	
Postcode *	SW2 5RJ
Registered number (where applicable)	
Description of applicant (for example partnership, company, unincorporated association etc.) *	LIMITED COMPANY
Email *	
Daytime Contact Telephone Number	

Variation

Do you want the proposed variation to take effect as soon as possible? *	Yes
--	-----

Variation

Do you want the proposed variation to have effect in relation to the introduction of the late night levy? (Please see Guidance Note 1)*	No
Briefly describe the nature of the proposed variation. (Please see Guidance Note 2) *	EXTENSION OF THE HOURS FOR LATE NIGHT REFRESHMENT
If your proposed variation would mean that 5,000 or more people are expected to attend the premises at any one time, please state the number.	

Operating Schedule

Complete those parts of the Operating Schedule below which would be subject to change if this application to vary is successful.

Provision of regulated entertainment (please read guidance note 3) *

Plays

Films

Indoor Sporting Events

Boxing or Wrestling

Live Music

Recorded Music

Performances of Dance

Anything of a similar description falling under Music or Dance

Provision of late night refreshment

Supply of Alcohol

Type of Variation - Late Night Refreshment

Please select the type of variation that applies to this activity.

*

Change an existing Activity

Late Night Refreshment Standard Times

Standard days and timings, where you intend to use the premises for late night refreshment. (please read guidance note 8) *
Please enter times in 24hr format (HH:MM)

Day *

Sunday

23:00

00:00

Late Night Refreshment Standard Times

Standard days and timings, where you intend to use the premises for late night refreshment. (please read guidance note 8) *
Please enter times in 24hr format (HH:MM)

Day *

Monday to Thursday

23:00

01:00

Late Night Refreshment Standard Times

Standard days and timings, where you intend to use the premises for late night refreshment. (please read guidance note 8) *
Please enter times in 24hr format (HH:MM)

Day *

Friday to Saturday

23:00

02:00

Late Night Refreshment

Will the provision of late night refreshment take place indoors or outdoors or both? (please read guidance note 4) *

Indoors

Please provide further details. (please read guidance note 5)

CUSTOMERS CONSUME OUR GREEK KEBABS INSIDE OUR RESTAURANT AND FOR TAKEAWAYS

State any seasonal variations for the provision of late night refreshment. (please read guidance note 6)

NONE

Please state any non-standard timings, where you intend to use the premises for late night refreshment at different times from the Standard days and times listed? (please read guidance note 7)

NONE

Adult Entertainment

Please highlight any adult entertainment or services, activities, other entertainment or matters ancillary to the use of the premises that may give rise to concern in respect of children. (please read guidance note 10)

NONE

Opening Hours Standard Times

Standard days and timings, where the premises are open to the public. (please read guidance note 8) * Please enter times in 24hr format (HH:MM)

Day *

Sunday

11:00

00:00

Opening Hours Standard Times

Standard days and timings, where the premises are open to the public. (please read guidance note 8) * Please enter times in 24hr format (HH:MM)

Day *

Monday to Thursday

11:00

01:00

Opening Hours Standard Times

Standard days and timings, where the premises are open to the public. (please read guidance note 8) * Please enter times in 24hr format (HH:MM)

Day *

Friday to Saturday

11:00

02:00

Opening Hours

State any seasonal variations. (please read guidance note 6)

NONE

Please state any Non-standard timings, where you intend the premises to be open to the public at different times from the Standard days and times listed? (please read guidance note 7)

NONE

Variation

Please identify those conditions currently imposed on the licence which you believe could be removed as a consequence of the proposed variation you are seeking.

NONE.

I agree to return the original premises licence or the relevant part of the original premises licence: *

Yes

Note: This application cannot be processed until the original licence is received or a statement as to why it cannot be returned has been accepted.

Licensing Objectives

Describe any additional steps you intend to take to promote the four licensing objectives as a result of the proposed variation:

a) General - all four licensing objectives (b, c, d and e)
(please read guidance note 11)

TO PROMOTE ALL FOUR LICENSING OBJECTIVES WE WILL KEEP: Extra strong management controls and effective training of all staff so that they are aware of the premises license and the requirements to meet the four licensing objectives with particular attention to: d (continued)0 • There shall be a dedicated area for delivery personnel to safely park their vehicle and collect the customer order. Delivery vehicles shall not be allowed to stop or park on Coldharbour Lane.

b) The prevention of crime and disorder

• All alcoholic products shall be covered at those times when the sale of alcohol is not permitted at the premises. • SIA trained and licensed door supervisors shall be employed on occasions when a requirement is identified by the licence holder's risk assessment.

c) Public safety

• Anyone who appears to be drunk or intoxicated shall not be allowed entry to the premises and those who have gained entry will be escorted from the premises immediately by the DPS or duty manager. • There shall be a duty manager or the DPS on duty at all times during the hours for Late Night Refreshment.

d) The prevention of public nuisance

• Management/staff shall proactively monitor the conduct and behaviour of patrons on the public highway to ensure no noisy, rowdy or anti-social behaviour (this includes loud talking/shouting and people congregating in large groups on pavement obstructing the public highway). Those patrons deemed to be engaging in such behaviour shall be asked to cease this activity and/or disperse from the premises quietly.

e) The protection of children from harm

Declarations

Declaration Type *

Sole Applicant - Individual or Other

Declarations

I have made or enclosed payment of the fee or. I have not made or enclosed payment of the fee because this application has been made in relation to the introduction of the late night levy. I have sent copies of this application and the plan to responsible authorities and others where applicable. I understand I must now advertise my application. I understand I must now return the original premises licence, or relevant part of it or have provided an explanation why I will not be able to do this. I understand that if I do not comply with the above requirements my application will be rejected.

IT IS AN OFFENCE, UNDER SECTION 158 OF THE LICENSING ACT 2003, TO MAKE A FALSE STATEMENT IN OR IN CONNECTION WITH THIS APPLICATION. THOSE WHO MAKE A FALSE STATEMENT MAY BE LIABLE ON SUMMARY CONVICTION TO A FINE OF ANY AMOUNT

Signature/Declaration of applicant (the current premises licence holder) or applicant's solicitor or other duly authorised agent (see Guidance Note 13). If signing/applying on behalf of the applicant, please state your name and in what capacity you are authorised to sign/apply. When submitting an on-line application form the 'Declaration made' checkbox must be selected.

Full Name *

HUGO JAMES ICHIRO USHIDA

Date *

26/07/2020

Capacity *

Applicant



Declaration made

Do you wish to provide alternative correspondence details? *

No

Email confirmation

On submission an email confirmation will be sent using the details below

Forename





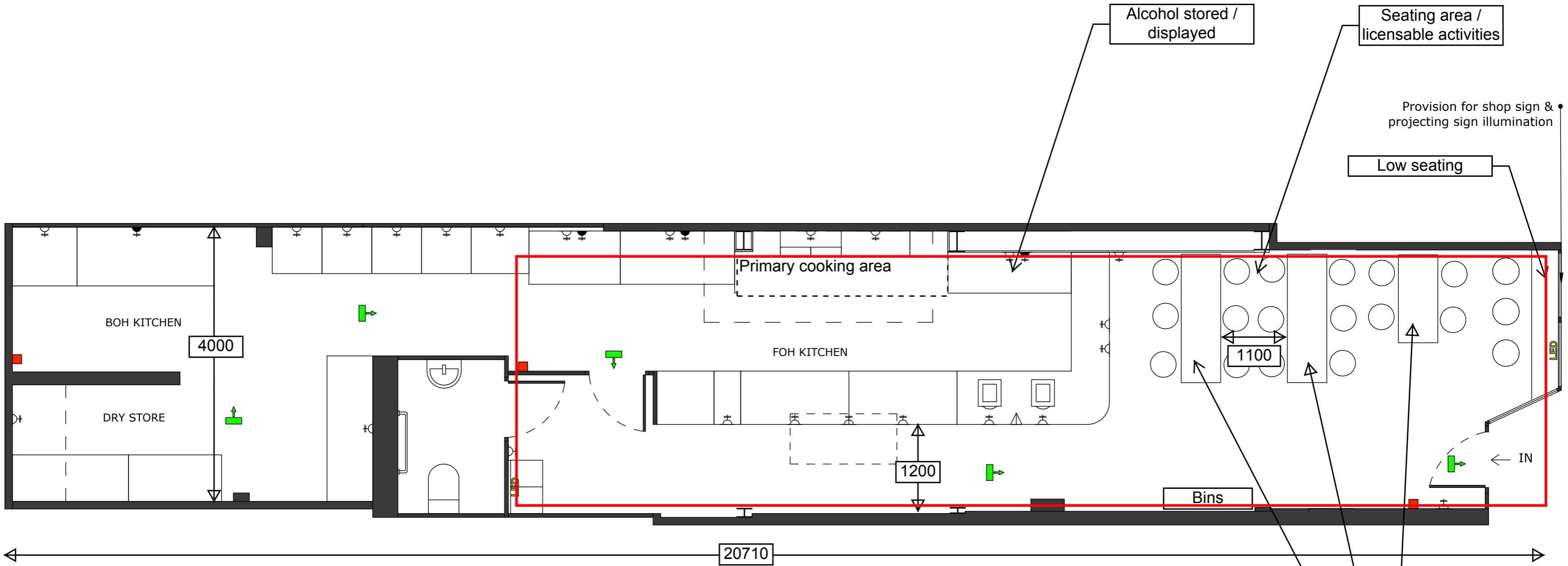

Surname /Company Name

PLANE TREE HOSPITALITY LTD

Email *

Telephone



-  Double Socket under worktop level
-  Double Socket above worktop level
-  Data connections for POS
-  Emergency Lighting
-  Fire call points
-  LED Provision for LED/Neon letters signage

Alcohol stored / displayed

Seating area / licensable activities

Low seating

Provision for shop sign & projecting sign illumination

1100

1200

4000

BOH KITCHEN

DRY STORE

Primary cooking area

FOH KITCHEN

Bins

High seating

20710

IN

LED

		Project	Mikos, 441 Coldharbour Lane, Brixton
		Title	Licensing Plan
		Date	24 April 2019
		Scale	1:50@A3