

London Borough of Lambeth  
 Consumer Protection & Sustainability  
 5<sup>th</sup> floor, Blue Star House  
 234-244 Stockwell Road  
 London  
 SW9 9SP  
 Tel: 020 7926 6108  
 Web: www.lambeth.gov.uk/licensing/



## Licensing Act 2003 Premises Licence

Premises Licence Number

Prem1598

Version Reference

12/01396/PRMNEW

### Part 1 – Premises Details

**Postal address of premises including Post Town & Post Code, or if none, ordnance survey map reference or description**

Local Express  
 500 Brixton Road  
 London  
 SW9 8EQ

**Telephone number**

**Where the licence is time limited the dates**

-

**Licensable activities authorised by the licence**

Supply of Alcohol

**The times the licence authorises the carrying out of licensable activities**

**Supply of Alcohol**

Monday - Sunday

00:00 - 00:00

**The opening hours of the premises**

Monday	00:00 - 00:00
Tuesday	00:00 - 00:00
Wednesday	00:00 - 00:00
Thursday	00:00 - 00:00
Friday	00:00 - 00:00
Saturday	00:00 - 00:00
Sunday	00:00 - 00:00

**Where the licence authorises supplies of alcohol whether these are on and/or off supplies**

Alcohol may be supplied for consumption off the premises

**Part 2**

**Name, (registered) address, telephone number and email (where relevant) of holder of premises licence**

Fawad Karimi



Email Address contact details



Mr Jan Matteen

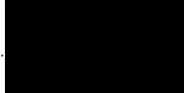

**Registered number of holder, for example company number, charity number (where applicable)**

**Name, address and telephone number of designated premises supervisor where the premises licence authorises the supply of alcohol**

Fawad Karimi

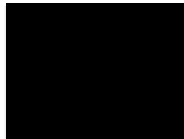

**Personal licence number and issuing authority of personal licence held by designated premises supervisor where the premises licence authorises the supply of alcohol**

Personal Licence No:



Licensing Authority: London Borough

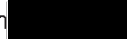

**Signed:**.....

On behalf of the Head  
of Consumer Protection  
and Sustainability

**Dated:**.....

## Annex 1 – Mandatory conditions

### 1 MANDATORY CONDITIONS (Alcohol - off)

#### Condition A1.

No supply of alcohol may be made under this licence:

- a) At a time that there is no designated premises supervisor in respect of the premises licence; or
- b) At a time when the designated premises supervisor does not hold a personal licence or his personal licence is suspended.

#### Condition A2.

Every supply of alcohol under this licence must be made or authorised by a person who holds a personal licence.

#### Condition A3.

- (1) The premises licence holder shall ensure that an age verification policy applies to the premises in relation to the sale or supply of alcohol.
- (2) The policy must require individuals who appear to the responsible person to be under 18 years of age (or such older age as may be specified in the policy) to produce on request, before being served alcohol, identification bearing their photograph, date of birth and a holographic mark.

## **Annex 2 – Conditions consistent with the Operating Schedule**

### **General**

Educating staff on appropriate behaviour towards the customers and current regulation standards with regards to the licensing, fire and health and safety regulations.  
Ensuring compliance, with up to date licensing, health and safety and fire regulations.  
The premises will be kept in an attractive state.  
Appropriate licensing signs will be displayed.  
CCTV will be installed.

### **The prevention of crime and disorder**

Ensuring CCTV is in working order with visible signs displayed at the premises.  
No sale of alcohol to people who appear to be drunk or under drug influence.  
A reasonable number of staff will be on the shop floor at all the times

### **Public Safety**

Fire extinguishers and Fire alarms are kept in working order.  
Fire exits will be kept clear.  
'Wet Floor' sign will be displayed when necessary.  
The premises floor will be kept uncluttered and clean.

### **The Prevention of Public Nuisance**

Staff will be discouraged from getting into arguments and will be polite and professional.  
All waste will be disposed of in an designated place.  
The licence holder will ensure that the premises frontage and interior in kept in an attractive state.

### **The Protection of Children from Harm**

No sale of alcohol, tobacco, inflammable objects to underage and related signs will be displayed in a visible place for customers.

## Annex 3 – Conditions attached after a hearing by the licensing authority

1 Licensing Sub Committee Hearing 30.08.2012

RESOLVED: To grant the application with amendments and conditions as follows:

### Amendment-

~~Hours reduced to 0700-0000 Monday to Sunday~~

### Conditions

#### CCTV

1. A CCTV system covering areas inside and directly outside the premises should be updated and maintained according to police recommendations with properly maintained log arrangements and recordings/tapes to be kept for a minimum of 30 days.
2. The CCTV system is to comply with the Data Protection Act 1998 and must be working and recording correctly when the venue is open to the public.
3. Daily checks of the CCTV system are to be completed and all details written into a log/diary.
4. A staff member from the venue who is conversant with the operation of the CCTV system must be on the premises at all times that the venue is open to the public. This staff member must immediately be able to show police or local authority officers contemporaneous and recent data or footage on request.
5. The premises are to use all reasonable efforts to provide police and local authority officers with recordings from the CCTV system on request (e.g. by supplying recordings on DVD, CD, tape etc and any software needed to play the footage if necessary)

#### Police Licensing Forums

6. A member of the premises management (whether the DPS or other owner/manager) must attend all Police Licensing forums/meetings when invited.

#### Signage

7. The premises shall prominently display signage informing customers:  
To leave quietly and to respect your neighbours  
Stating that CCTV is in operation and police have instant access to the footage

#### General

8. This condition has been removed following the appeal on the 29.04.2013
9. There will be no sales/supplies of beers, ales, lagers or ciders or anything similar of 6% ABV or above save for Nigerian Guinness and Dragon Stout
10. Two (2) members of staff will be present at the venue at all times it is open to the public and licensable activities are taking place, one of whom must have a personal licence
11. The venue will not sell/supply miniature bottles of spirits of 50ml or less except when purchased with groceries
12. Challenge 25 policy to be implemented

Annex 4 – Plans

Local Express  
Premises licence application

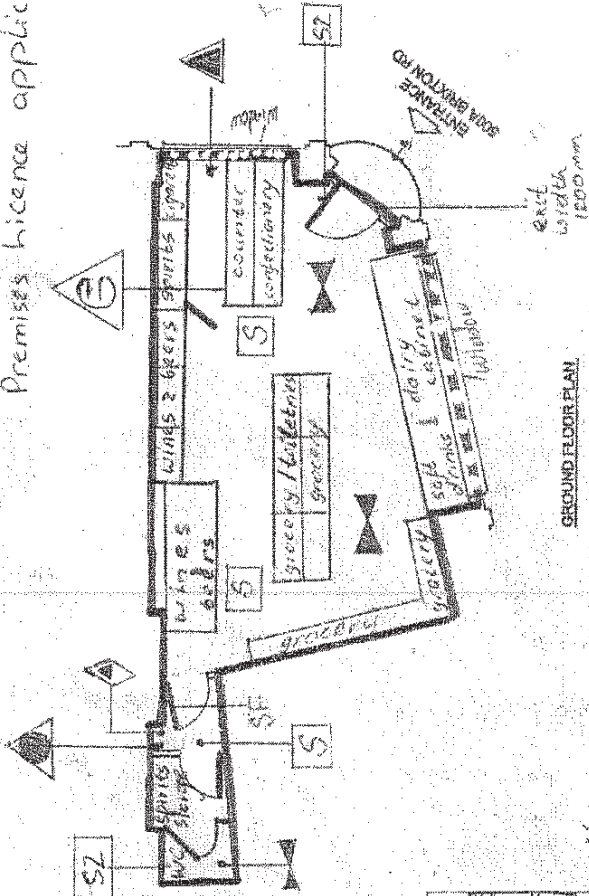

LEASE PLAN  
GROUND FLOOR  
500 BRIXTON ROAD  
BRIXTON  
LONDON  
SW9 8EQ

JUNE 11

SCALE 1 : 100 @ A4



Key:

- ▲ Foam Fire Extinguisher 27A 182B
- ◆ Fixed Fire Extinguisher installation (Co2)
- ▲ Carbon Dioxide fire Extinguisher
- ▲ Fire Blanket in container
- ▲ Escape lighting on or adjacent BS
- ▲ Area covered by fire-rated Smoke Detectors
- ▲ No smoking sign
- ◆ Doors with simple fastening only

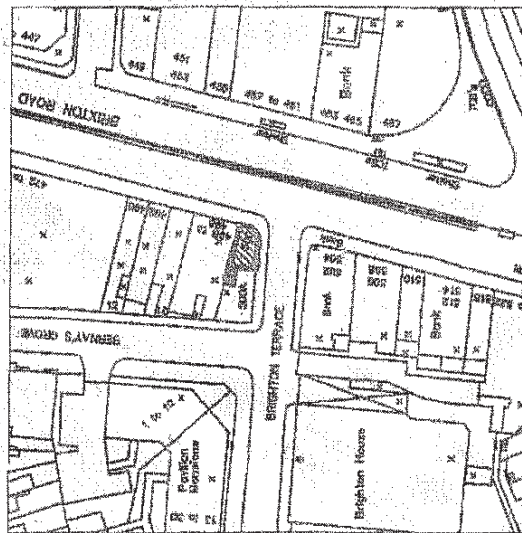

D.S. SITE LOCATION PLAN - Scale 1 : 1250